

BARRIER PRODUCT CATALOG



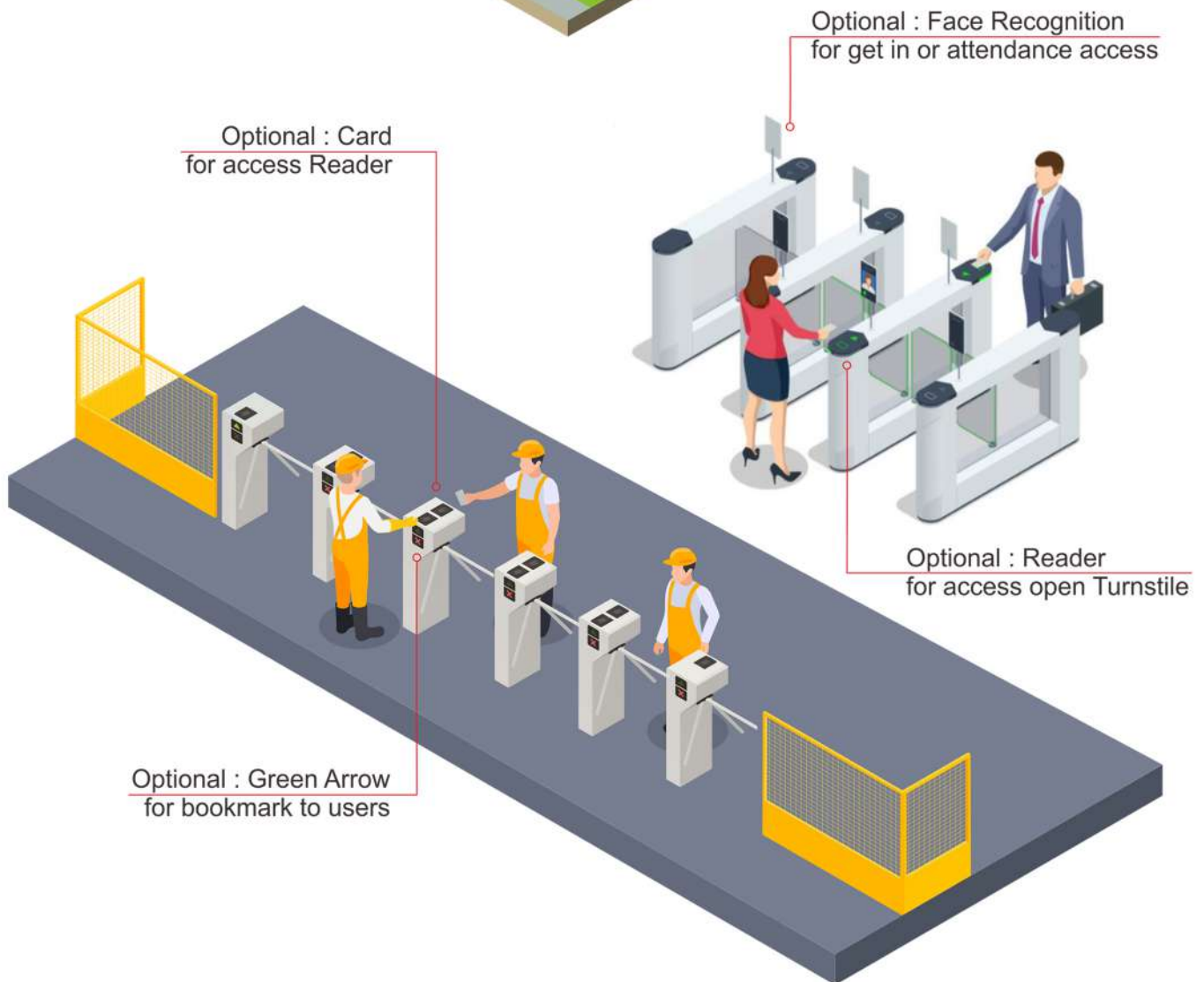
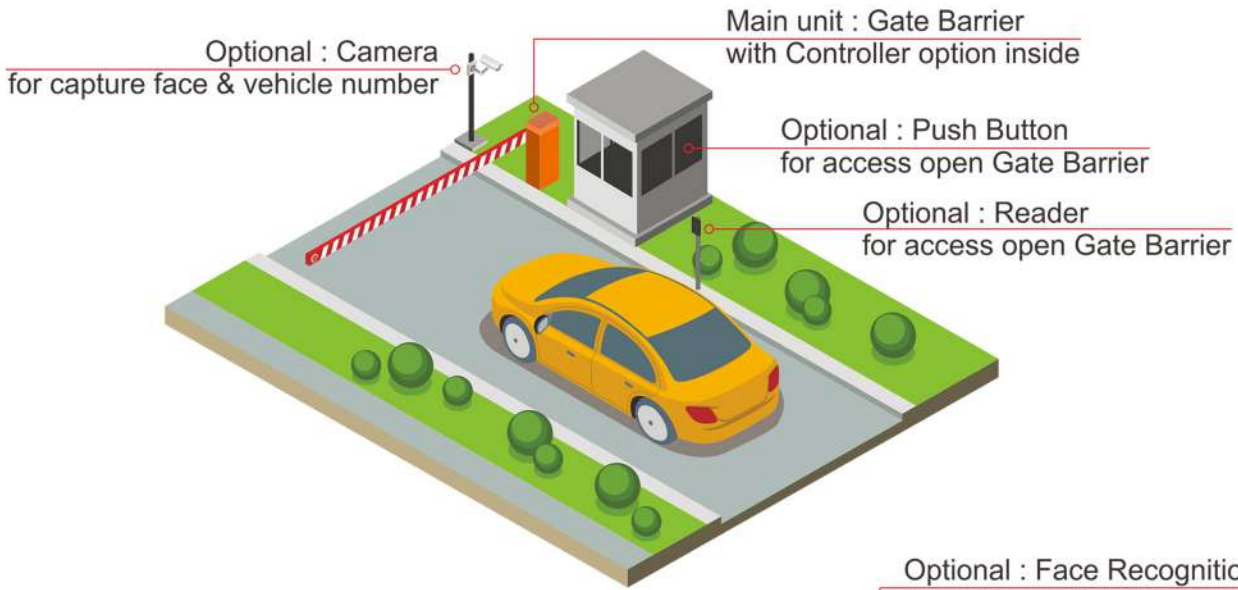

Table of Content

Tripod Standard Turnstile	01
Tripod Slim Turnstile	02
Tripod Slim With Soap Dispenser.....	03
Double Tripod Slim Turnstile	04
Double Tripod Turnstile	05
Swing Gate Turnstile 01	06
Swing Gate Turnstile 02.....	08
High-End Swing Gate Turnstile	10
U Swing Gate Turnstile	12
Flap Barrier Turnstile	13
Full Height Turnstile	14
Gate Barrier.....	15

Pedestrian Access Icon

Walking Access

Walking with suitcase

Walking with luggage

Staircase Access

Tripod Standard Turnstile KK-100

Application

Office and administrative buildings .Ministries and public, buildings Banks and financial institutions Industrial installations, Residential areas Schools, colleges and universities.

Standard Equipment

- Solenoid valve driving.
- Top cover indicator.

Operating Environment

- Indoor outdoor, -15 C° 60 C°.
- IP54.
- MTBF 3 million times.

Electrical Equipment

- Power supply voltage : AC220V±10V, 50Hz.
- Relative humidity : ≤ 95%, no condensation.
- Channel width : ≤ 550mm.
- Passing width : ≤ 600mm.
- Passing speed : 40 people/minute (IC card).
- Opening speed : Fastest 1.5s, adjustable.
- Input interface : Dry Contact.
- Communication interface : RS485 electrical standard.
- Communication distance : ≤ 1200 meters.

Dimension and material

- Size : 1200*280*1000 mm.
- Materials : SUS304 brushed stainless steel.

* Design & dimension subject to change without prior notice, please contact us for further information.

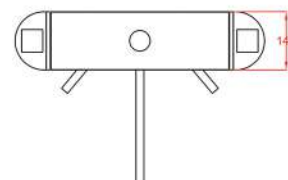
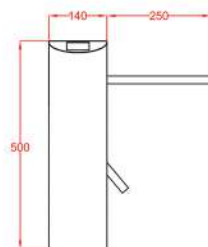
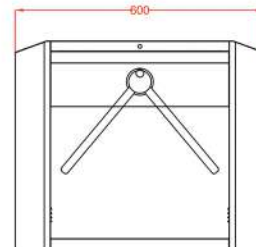

Tripod Slim Turnstile KK-101

Application

Office and administrative buildings . Ministries and public, buildings
Banks and financial institutions Industrial installations, Residential areas
Schools, colleges and universities.

Standard Equipment

- Driving motor : Solenoid Valve Driving.
- Passing LED indicator : Top cover indicator.
- Direction of passing : Uni-directional/Bi-directional.
- Noise : <50dB.

Operating Environment

- Indoor/Outdoor, - 15 C°~60 C°.
- IP54.
- MTBF 3 million times.

Electrical Equipment

- Voltage : AC110V/AC220V±10% 50-60Hz.
- Passing width : ≤ 550mm.
- Relative humidity : ≤ 90%, no condensation.
- Opening speed : Fastest 1.5s, adjustable.
- Passing speed : 20 people/min (IC card).
- Communication interface : RS485.
- Communication distance : ≤ 1200m.
- Input interface : Dry contact.

Dimension and Material

- Size : 420*380*980 mm.
- Cabinet material : SUS304 stainless steel.

* Design & dimension subject to change without prior notice,
please contact us for further information.

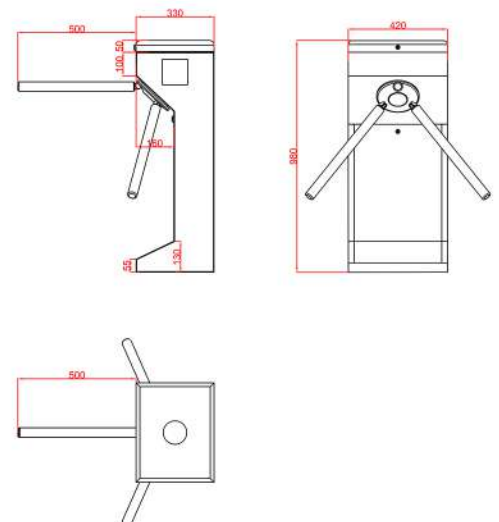

Tripod Slim with Soap Dispenser KK-MSL-01

Hygiene is health efforts by maintaining and protecting the subject hygiene such as washing hands with soap and clean water to protect the hand hygiene and break the chain of germs that can contaminate other good which occurs through direct contact with unclean hands. With the increasing demand for industrial hygiene in places such as the manufacture of chemical, pharmaceutical, food and beverage, hygiene tunstile are necessary. With the function sanitizer dispensers will ensure that personnel through the turnstile so that the cleaning solution is given, to guarantee hygiene especially on the hands.

FEATURES

- Model Available KK-MSL-01 (Tripod Slim with Soap Dispenser).
- Cleaning washing and disinfectant germs activity more easily and regularly before entering the production area.
- Eliminates contamination risk.
- Automatic foam care dispenser in stainless steel box up.
- Low level indication for disinfectant.
- Easy accessible by removable front.

SPECIFICATIONS SOAP DISPENSER

Dispensing dosage : Output 0,5 ml per-close (Approx 2000 washes per fill).

Power supply : 3 "C" cell alkaline batteries.

Detecting distance : Preset at 10 cm, 2 - 20 cm adjustable.

Response time : 1,2 seconds.

Battery Life : 12 months or 50,000 usages.

Dimensions : 240mm (H) x 140mm(W) x 90mm(D).

* Design & dimension subject to change without prior notice, please contact us for further information.

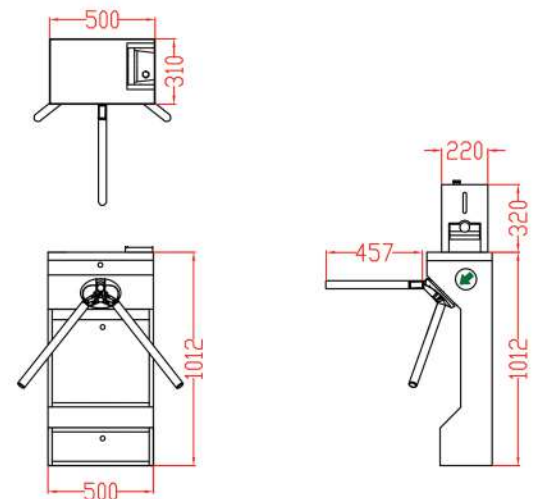

Double Tripod Slim Turnstile KK-103

Application

Office and administrative buildings. Ministries and public, buildings Banks and financial institutions Industrial installations, Residential areas Schools, colleges and universities.

Standard Equipment

- Solenoid valve driving.
- Top cover indicator.

Operating Environment

- Indoor outdoor, -15 C° 60 C°.
- IP54.
- MTBF 3 million times.

Electrical Equipment

- Power supply voltage : AC220V±10V, 50Hz.
- Relative humidity : ≤ 95%, no condensation.
- Channel width : ≤ 550mm.
- Passing width : ≤ 600mm.
- Passing speed : 40 people/minute (IC card).
- Opening speed : Fastest 1.5s, adjustable.
- Input interface : Dry Contact.
- Communication interface : RS485 electrical standard.
- Communication distance : ≤ 1200 meters.

Dimension and material

- Size : 500*420*980 mm.
- Materials : SUS304 brushed stainless steel.

* Design & dimension subject to change without prior notice, please contact us for further information.

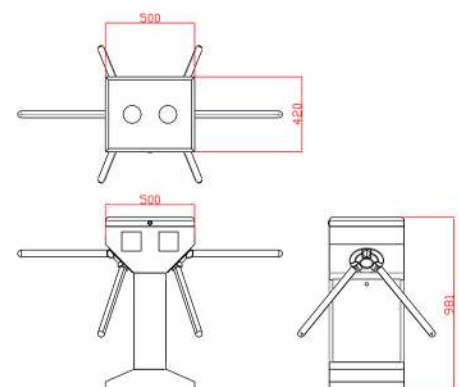

Double Tripod Turnstile KK-102

Application

Office and administrative buildings .Ministries and public, buildings Banks and financial institutions Industrial installations, Residential areas Schools, colleges and universities.

Standard Equipment

- Solenoid valve driving.
- Top cover indicator.

Operating Environment

- Indoor outdoor, -15 C° 60 C°.
- IP54.
- MTBF 3 million times.

Electrical Equipment

- Power supply voltage : AC220V±10V, 50Hz.
- Relative humidity : ≤ 95%, no condensation.
- Channel width : ≤ 550mm.
- Passing width : ≤ 600mm.
- Passing speed : 40 people/minute (IC card).
- Opening speed : Fastest 1.5s, adjustable.
- Input interface : Dry Contact.
- Communication interface : RS485 electrical standard.
- Communication distance : ≤ 1200 meters.

Dimension and material

- Size : 1600*260*1010 mm.
- Materials : SUS304 brushed stainless steel.

* Design & dimension subject to change without prior notice, please contact us for further information.

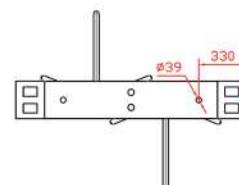
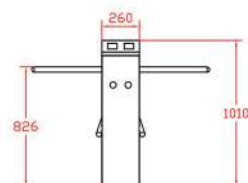
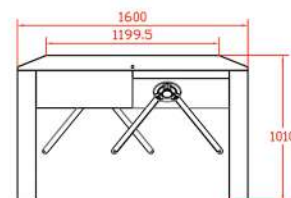

Swing Gate Turnstile 01 KK-111B/112B

Application

Office and administrative buildings .Ministries and public, buildings
Banks and financial institutions Industrial installations, Residential areas
Schools, colleges and universities.

Standard Equipment

- Driving motor DC brushless motor.
- Arm Material acrylic or stainless steel for optional.

Operating Environment

- Indoor, -25 C° - 70 C°.
- IP 54.
- MTBF 3 million times.

Electrical Equipment

- Power supply voltage : AC 220 ± 10% V 50 ± 10 % HZ.
- Infrared sensor : 4 groups, can extend to 8 groups.
- Relative humidity : ≤ 90%, no condensation.
- Method of Positioning : Use the encoder to make sure the swing gate position.
- Direction of passing : Uni-directional/Bi-directional.
- Passing LED indicator : Motor and arm with LED indicator.
- Passing width : ≤ 1050mm.
- Passing speed : 35-40 people/min.
- Opening speed : Adjustable, fastest 0.5s.
- Angle of gate opening : 90°±5 °.
- Startup Time : 3 seconds.
- Communication interface : RS485, TCP/IP interface.



- Input signal : Dry contact signal or +12V level signal or DC 12V pulse signal with width of more. than 100ms, driving current >10mA.
- Angle of gate opening : $90^{\circ} \pm 5^{\circ}$.
- Power : 40w.

Dimension and material

- Size : 1400*200*1000 mm.
- Materials : SUS304 brushed stainless steel.

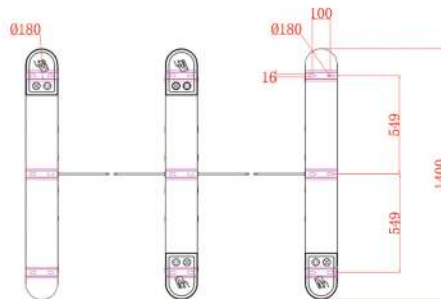
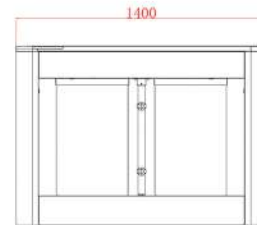
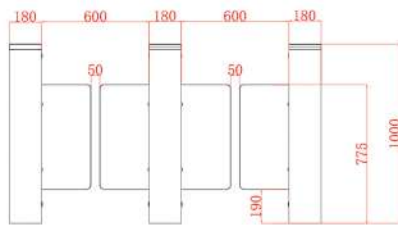

* Design & dimension subject to change without prior notice, please contact us for further information.

Swing Gate Turnstile 02 KK-111A/112A

Application

Office and administrative buildings .Ministries and public, buildings
Banks and financial institutions Industrial installations, Residential areas
Schools, colleges and universities.

Standard Equipment

- Driving motor DC24V brushless motor.
- Acrylic or stainless steel for optional.

Operating Environment

- Indoor, -25 C° ~70 C°.
- IP 55.
- MTBF 5 million times.

Electrical Equipment

- Power supply voltage : AC 220 ± 10% V 50 ± 10% HZ.
- Passing LED indicator : LED indicator.
- Method of positioning : Brushless motor + clutch + encoder.
- Direction of passing : Uni-directional/Bi-directional.
- Passing width : 600~1200mm.
- IR sensor : Standard 6 pairs can extend to 10 pairs.
- Working environment : Indoor/Outdoor, -25°C~70°C.
- Relative humidity : ≤ 90%, no condensation.
- Opening speed : Fastest 0.5s, adjustable.
- Passing speed : 35-40 people/min.
- Angle of gate opening : 90°±5 °.
- Noise : < 50dB.
- Communication interface : Level/Pulse/RS485/RS232.
- Input interface : Relay(dry contact).
- Power : 30W(left/right), 60W(middle).



Dimension and material

- Size : 1600*210*1000mm.
- Materials : SUS304 brushed stainless steel.
- Arm material : Acrylic.

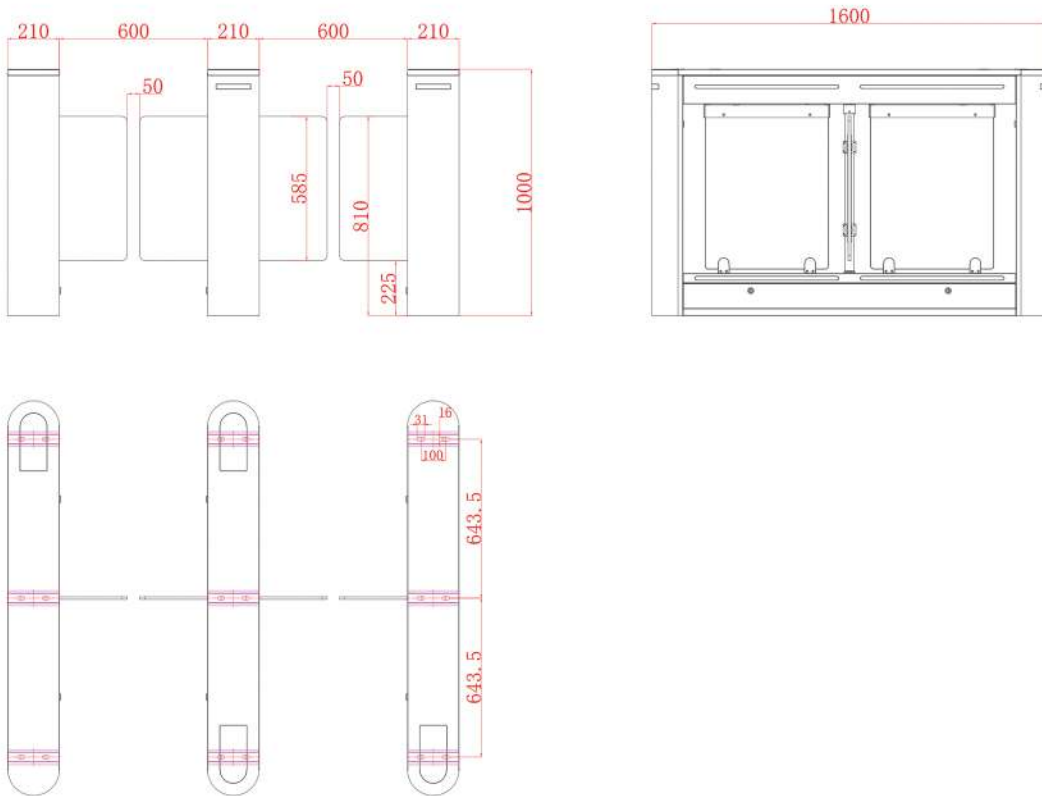

* Design & dimension subject to change without prior notice, please contact us for further information.

High-End Speed Swing Gate Turnstile KK-141

Application

Office and administrative buildings .Ministries and public, buildings Banks and financial institutions Industrial installations, Residential areas Schools, colleges and universities.

Standard Equipment

- Driving motor DC24V servo motor.
- Acrylic (tempered glass for optional).
- Colour (Champagne gold+black & titanium grey+black & titanium black+black for optional).

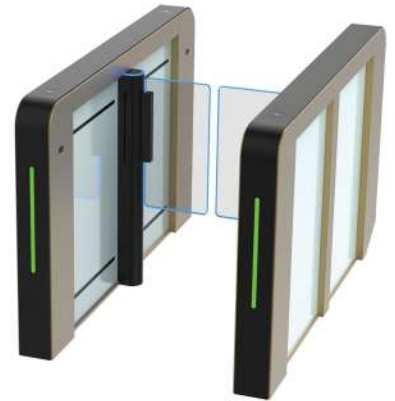

Operating Environment

- Indoor, -25 C° - 70 C°.
- IP42.
- MTBF 20 million times.

Electrical Equipment

- Power supply voltage : 100W(left/right), 200W(middle).
- Relative humidity : ≤ 90%, no condensation.
- Method of Positioning : servo motor + clutch + encoder.
- Direction of passing : Uni-directional/Bi-directional.
- Passing LED indicator : Motor and arm with LED indicator.
- Passing width : 600~900mm.
- IR Sensor : 14 Pairs.
- Passing speed : 35-40 people/min.
- Opening speed : Fastest 0.3s, adjustable.
- Input interface : Relay (Dry Contact).
- Angle of gate opening : 90°±5 °.
- Noise : < 50dB.
- Communication interface : Level/Pulse/RS485/RS232.

Dimension and material

- Size : 1600*280*980mm.
- Materials : SUS304 brushed stainless steel.

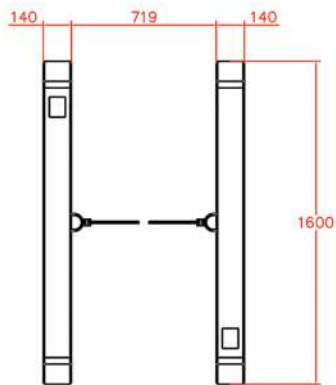
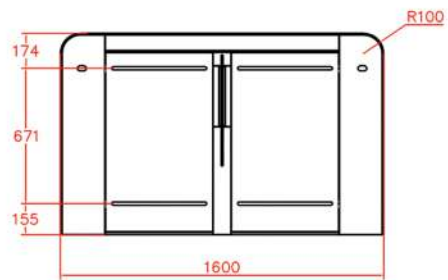
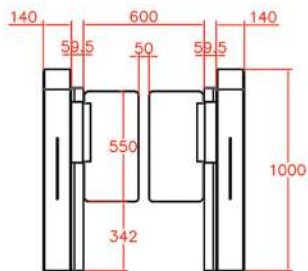

* Design & dimension subject to change without prior notice, please contact us for further information.

U Swing Gate Turnstile KK-SW-01

Application

Office and administrative buildings . Ministries and public, buildings Banks and financial institutions Industrial installations, Residential areas Schools, colleges and universities.

Standard Equipment

- Driving motor : Servo motor.
- Method of position : Use the encoder to make sure the swing gate position.

Operating Environment

- Indoor 15 C°~+60 C°.
- IP24.
- MTBF 5 million times.

Electrical Equipment

- Voltage : AC220 ± 10% V,50Hz.
- Passing width : ≤600mm.
- Opening speed : Fastest 0.5s, adjustable.
- Passing speed : 30 - 35 person/min.
- Operating Power : Single Motor 30w, Double Motor : 60w.
- Communication interface : RS485.
- Communication distance : ≤1200m.
- Input Signal : Dry contact signal or + 12v level signal or DC 12 V pulse signal with width or more than 100ms,driving current > 10 ma.

Dimension and Material

- Size : 141*141*1008 mm.
- Cabinet material : SUS304 Brushed Stainless Steel whole body 2.0 mm Acrylic swing arm.

* Design & dimension subject to change without prior notice, please contact us for further information.

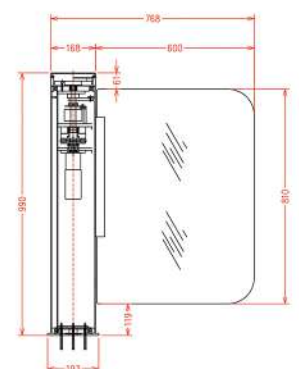
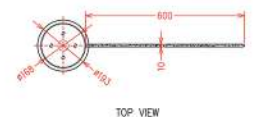

Flap Barrier Turnstile KK-131A/132A

Application

Office and administrative buildings .Ministries and public, buildings
Banks and financial institutions Industrial installations, Residential
areas Schools, colleges and universities.

Standard Equipment

- Driving motor DC24V brushless motor.
- Acrylic (tempered glass for optional).
- Colour black.

Operating Environment

- Indoor, 20 C° - 70 C°.
- IP22.
- MTBF 8 million times.

Electrical Equipment

- Power supply voltage : 40W (left/right), 60W(middle).
- Relative humidity : ≤ 90 %, no condensation.
- Method of Positioning : Brushless motor + clutch + encoder.
- Direction of passing : Uni-directional/Bi-directional.
- Passing width : 550 mm.
- IR Sensor : 6 Pairs.
- Passing speed : ≥ 35 people/min.
- Opening speed : Adjustable, fastest 0.5S.
- Input interface : Relay (Dry Contact).

Dimension and material

- Size : 1600*280*980mm.
- Materials : SUS304 brushed stainless steel.
+ Cold rolled sheet spray process.

* Design & dimension subject to change without prior notice,
please contact us for further information.

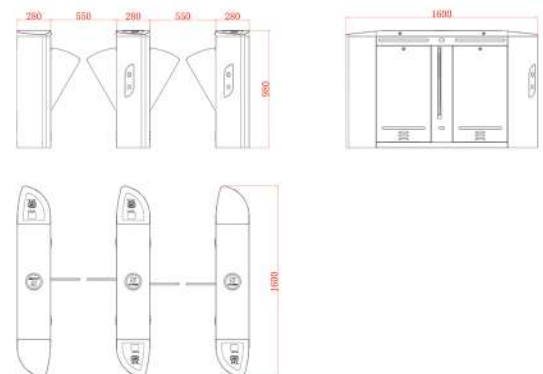

Full Height Turnstile KK-121A/121B

Application

The Full Height main field of application Industrial installations, Residential areas, Gymnasium, Scenic spots, Residential areas.

Model Available : KK-121A (Full- Height Turnstile 90°).
: KK-121B (Full- Height Turnstile 120°).

Standard Equipment

- Top cover arm : 2.0mm, whole body 1.5mm.
- Arm : Stainless steel.
- Driving motor : DC brushless motor.

Operating Environment

- Working temp : 25 C°~+70 C°.
- IP65.
- MTBF 5 million times.

Electrical Equipment

- Voltage : AC110V/AC220V±10% 50-60Hz.
- Passing width : ≤650mm.
- Passing speed : 20-35 personal/min.
- Method of Position : Motor driving.
- Input signal : Dry contact.

Dimension and Material

- Size : 1630*1500*2310 mm.
- Material : US304 brushed stainless steel

* Design & dimension subject to change without prior notice, please contact us for further information.

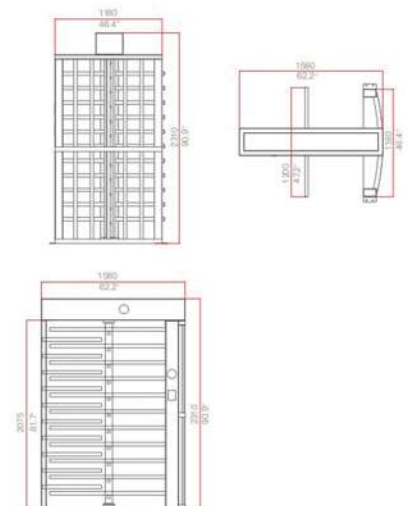

Gate Barrier KK-200

Keylok Gate Barrier Is the perfect choice of mobility of your parking area, with a speed of 1.8 seconds the activity closes and opens the bar almost without pause.

The present design with additional LEDs in the Body and supports an LED gate / arm gate as well. Very fashionable and elegance.

Keylok Gate Barrier is very suitable to be installed in the Mall, Offices that require maximum speed and a contemporary parking bar design.

Spesifikasi :

Model Available	: KK-200 (<i>Gate Barrier</i>).
Arm Length	: 4m (<i>Octagonal - Aluminium</i>).
Working Temperature	: -40°C to 75°C.
Power Supply	: 110/220V (10%).
Power Frequency	: AC 50/60Hz.
Rated Power	: 80 w.
Relative Humidity	: < 90%.
Arm Speed	: 1,8 seconds.
Internal Lubrication	: Grease.
Dimensions	: 315 x 392 x 1030 mm.

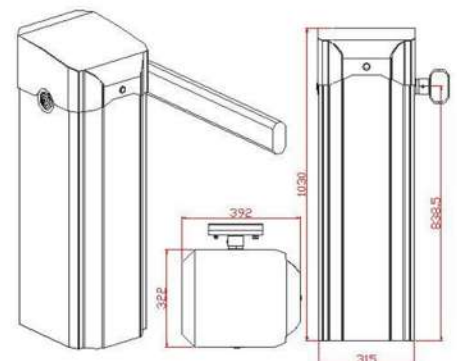

* Design & dimension subject to change without prior notice, please contact us for further information.

Head Office :

47 Kallang Puding Road, Singapore

☎ : +62 821-4004-6997

✉ : sales@keylokglobal.com